



**simply  
smarter  
broadband**

## **TP-Link Powerline – TL-WPA8631P KIT**

### **Installation Guide**



## Getting Started

### Equipment you will need



Router



x1 CAT 5e



X1 TP-Link Kit



x1 extra unit (if required)

# Installation

## Step 1

*Plug the adapter into a power outlet and connect it to the router's LAN port with an ethernet cable.*



## Step 2

*Plug the extender into a power outlet on the same electrical circuit. Wait until the extender's Powerline LED turns on.*

- If only one wall socket is available, plug both devices into a power strip for setup, then relocate to wall outlets*
- If the extender's Powerline LED is off, try another wall outlet, or refer to [Create a Secure Powerline Network by Pairing](#).*

**Plug and Play in Seconds!**

Tip: Press 'Pair' for more security.

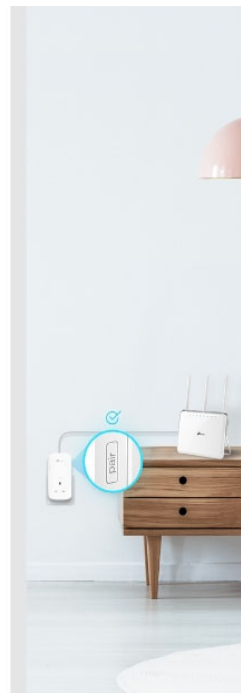

## Step 3

*Connect your devices to the internet using the default SSID (network name) and password on the label at the side of the extender. Enjoy!*

## Installation

### Create a Secure Powerline Network by Pairing

*Note: You can only pair two devices at a time. We recommend plugging in the powerline devices near each other when pairing.*

- *Press the pair button on the adapter for 1 second. The Powerline LED will start blinking. If the Power LED does not blink, press the pair button again.*
- *Within 2 minutes, press the extender's pair button for 1 second. The Power LED will start blinking.*
- *When the extender's Powerline LED turns on, a powerline network has been successfully created.*

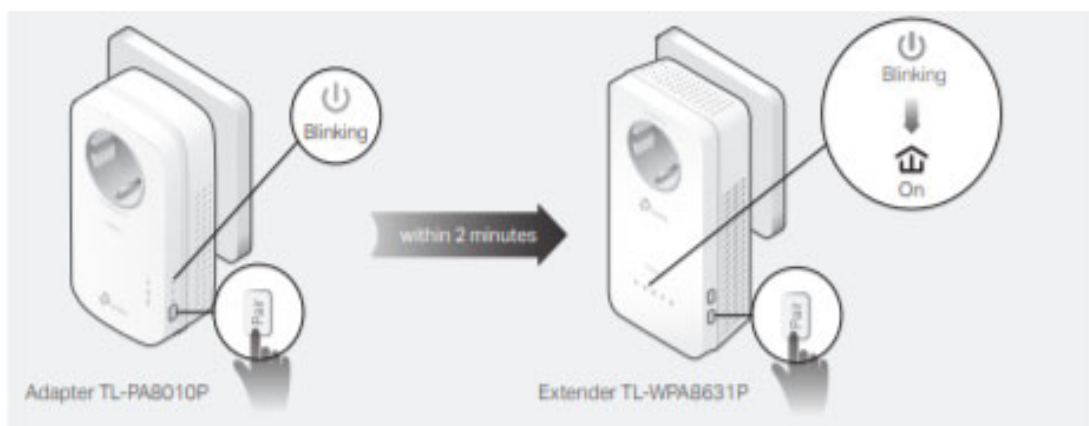

# Mesh Technology

(Available for TP-Link EX 220 G2u)

## Unify your Wi-Fi Network

### Method ONE: via Wi-Fi button

(Use this method when your router has a WPS button)

- Copy the SSID and password from the router
- Press the router's WPS button
- (Within 2 minutes) press the extender's Wi-Fi button for 1 second. The extender's 2.4 GHz and 5 GHz Wi-Fi LED's will start blinking. When they remain on, Wi-Fi settings are copied. If the Wi-Fi settings are not copied within 2 minutes, manually change the extender's Wi-Fi settings.

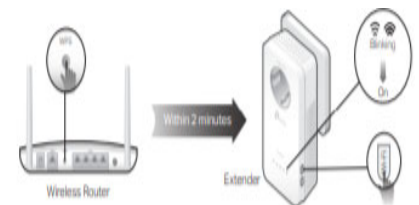

### Method TWO: via OneMesh

(Use this method when your router supports OneMesh)

- Copy your SSID and password from your router
- Connect the computer to the extender wirelessly.
- Visit [tplinkplc.net](http://tplinkplc.net). Go to OneMesh and toggle Join OneMesh. When the extender's 2.4GHz and 5GHz Wi-Fi LEDs turn on, Wi-Fi settings are copied.

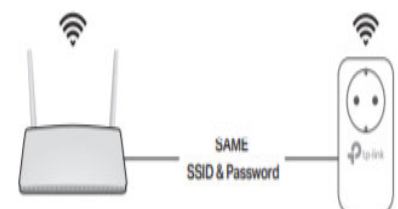

## Mesh Technology

### Download the TP-Link app



*Apple:* <https://apps.apple.com/gb/app/tpplc/id1035578020>

*Android:* <https://play.google.com/store/apps/details?id=com.tplink.tpplc>

